

**Eeshani's
LOTUS PARK**

FIRST, SECOND, THIRD, FOURTH AND FIFTH FLOOR PLAN

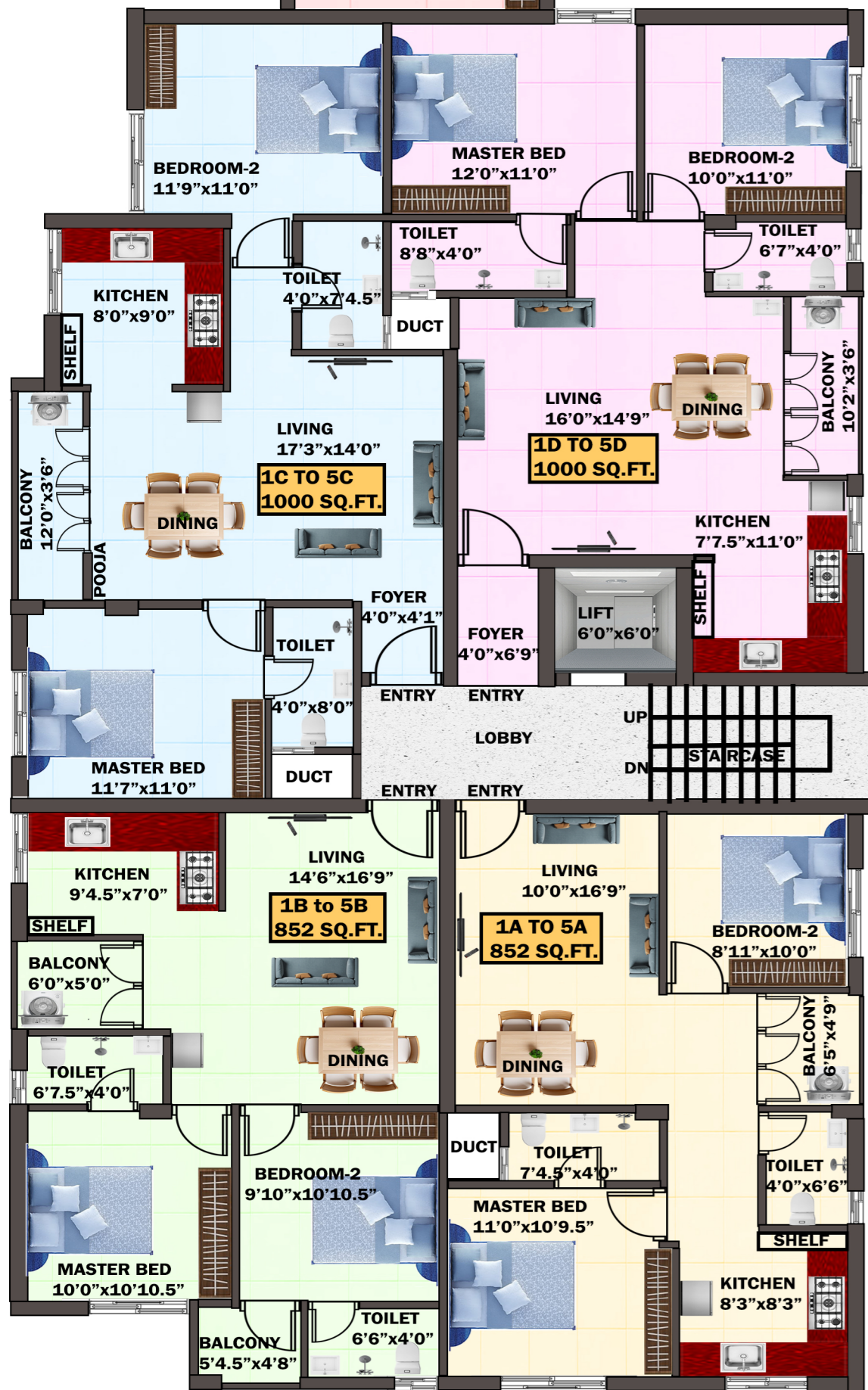

TOTAL NO. OF APARTMENTS - 40 NOS - AREA STATEMENT

Sl.No	Apartment No	Apartment Area in Sq.ft.	UDS Area in Sq.ft.	Floor	Apartment Type	Main Door Facing
1.	1A, 2A, 3A, 4A & 5A	852	280	First, Second, Third, Fourth & Fifth	2 BHK	North
2.	1B, 2B, 3B, 4B & 5B	852	280	First, Second, Third, Fourth & Fifth	2 BHK	North
3.	1C, 2C, 3C, 4C & 5C	1000	329	First, Second, Third, Fourth & Fifth	2 BHK	South
4.	1D, 2D, 3D, 4D & 5D	1000	329	First, Second, Third, Fourth & Fifth	2 BHK	South
5.	1E, 2E, 3E, 4E & 5E	1410	463	First, Second, Third, Fourth & Fifth	3 BHK	East
6.	1F, 2F, 3F, 4F & 5F	1315	432	First, Second, Third, Fourth & Fifth	3 BHK	West
7.	1G, 2G, 3G, 4G & 5G	1180	388	First, Second, Third, Fourth & Fifth	3 BHK	East
8.	1H, 2H, 3H, 4H & 5H	1116	367	First, Second, Third, Fourth & Fifth	3 BHK	West



Scan for Office Location



FOR BOOKING CONTACT
M. SIVA M.E.(Structural)
7797 012345
9566 434343

Scan for Site Location



OFFICE ADDRESS:

Plot No.38, Ground Floor, Alamelumangapuram 2nd Cross Street, Madipakkam, Chennai - 600 091.
Landmark - Backside of IndusInd Bank & Anjakha Hospital

SITE ADDRESS:

New No.7, Dr. Solomon Street, Rajaji Nagar, Pallavaram, Chennai - 600 043.
Landmark - Dharga Road Subway and 100 meters from Pallavaram Railway Station

www.eeshanibuilders.com

OUR OTHER ONGOING PROJECTS

Chromepet:	Zamin Pallavaram:	Ullagaram:	Adambakkam:	Madipakkam:
<ul style="list-style-type: none"> Anbhagam Akula Enclave Srinivasam Chandravadhane 	<ul style="list-style-type: none"> Narmadha Poornimaa 	<ul style="list-style-type: none"> Elite Residencia Virugambakkam: PSP Palace 	<ul style="list-style-type: none"> Meena Vilasam Devi Veera Blossom 	<ul style="list-style-type: none"> Padmavati

DR SOLOMON STREET - 30 FEET ROAD